

ALL CITY TREE (S) WITHIN 5 METERS OF THE CONSTRUCTION SITE TO INCLUDE:

- DIAMETER AT BREAST HEIGHT (DBH). TO BE MEASURED AT 1.2m ABOVE GROUND.
- SPECIES.
- LOCATION AND DIMENSION OF THE TREE PROTECTION ZONE (TPZ).
- A DETAIL OF THE (TPZ) FENCING.
- ALL EXISTING AND PROPOSED INFRASTRUCTURE CHANGES WITHIN THE (TPZ), EG. STRUCTURES, UTILITY SERVICES, HARD SURFACES.
- ACCESS POINTS TO THE CONSTRUCTION SITE TO BE DEFINED ON THE PLAN.
- LOCATION OF PROPERTY LINE.
- ALL UTILITY LOCATIONS ARE TO BE IDENTIFIED PRIOR TO ANY GROUND DISTURBANCE. AND ADHERE TO SAFE DIG PRACTICES AND SETBACK REQUIREMENTS.
- REFER TO CITY OF EDMONTON TREE PROTECTION GUIDELINES AND DETAILS FOR WRITTEN PROPOSAL REQUIREMENTS, AND ADDITIONAL CITY OF EDMONTON TREE PROTECTION INFORMATION.

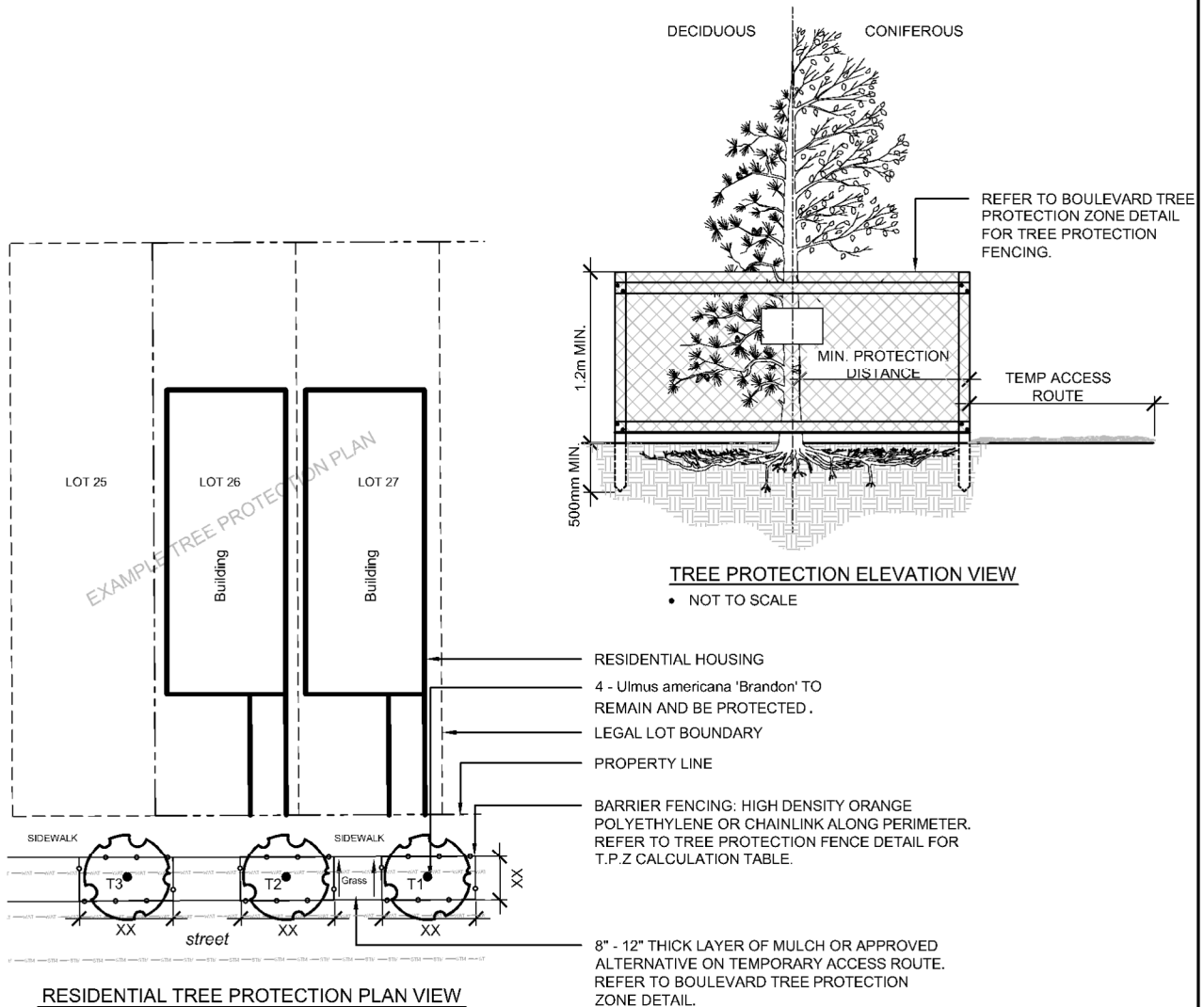

TREE PROTECTION SCHEDULE

TREE #	TREE SPECIES (can be found at yestreetmap)	TREE SIZE MEASURED 1.2m ABOVE GROUND (cm)		FENCING TOTAL PER TREE
		DBH (cm)	CIRCUMFERENCE (cm)	
-	-	DBH (cm)	CIRCUMFERENCE (cm)	W X L
T1	BRANDON ELM	12cm	37cm	2.4m x 1.2m



RESIDENTIAL TREE PROTECTION PLAN

Date Approved: JUNE 2017	Drawn By: PARKS PLANNING	Approved:	Revision	Drawing No. LA101
Scale: N.T.S.	Checked By: PARKS PLANNING			Old Drawing No. SP403a