

Floor Plan Standard - Industrial

Standard applies only to development permit (zoning approval) applications. Standards differ for building permit applications. Standards apply to business owners working without a contractor. Professionals must adhere to industry drawing standards.

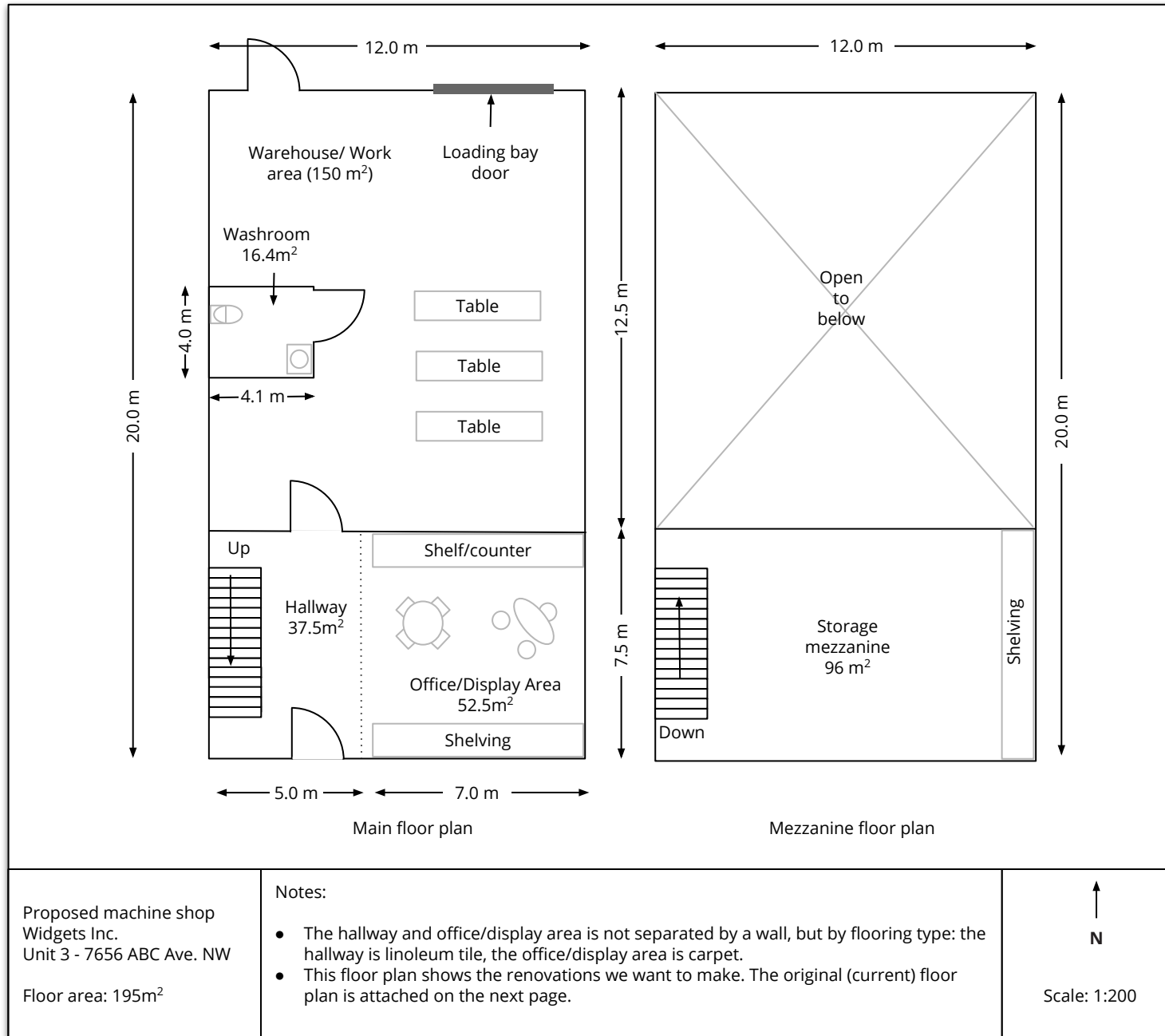

Drawings must contain all items in the checklist. Submitting incomplete drawings will delay application processing.

- Drawing Instructions**
- Metres or feet/inches are accepted. Please use units consistently.
 - Diagrams must be drawn to scale. Minimum scale is 1:100. Tip: Use graph paper to draw to scale.
 - Submit separate diagrams showing the current space and proposed changes.
 - Submit one diagram for simple changes only. Changes must be clearly marked.

- Floor Plan Checklist**
- Information bar:
- Type of business (example: machine shop)
 - Business name
 - Address including suite number
 - Floor area
 - North arrow and scale indicator

- Floor plan details:
- Locations of all internal and external facing walls, partitions, doorways, windows and other openings
 - Use and function of rooms
 - Dimensions of all rooms
 - Location and description of fixed/large furniture and equipment

- Industrial floor plan details:
- Area calculations of different uses

Checklists identify the minimum information required for application review. More information may be requested during application review.